

LEGEND		
SYB	ITEM	QTY
	Water Meter +- 40 gpm (by city)	1
	1.5" Double Backflow	1
	Rain Bird ESP Controller w/ (1) Module	1
	Hunter Rain-Click Sensor	1
	Rain Bird 150-PEB	4
	Rain Bird XCZ-100-PRF Valve/Regulator/Filter	2
	Rain Bird 1806/MP 1000 (900 to 2100)	12
	Rain Bird 1806/MP 2000 (900 to 2100)	114
	Rain Bird 1806/MP 2000 (2100 to 2700)	4
	Rain Bird 1806/MP 2000 (3600)	15

ZONE	TYPE	GPM	PIPE
V1	RAIN BIRD 1806 / MP Rotator Nozzle	+ 30.82	1355'
V2	IN LINE DRIP / MICRO SPRAY	+ 20	791'
V3	RAIN BIRD 1806 / MP Rotator Nozzle	+ 28.03	540'
V4	RAIN BIRD 1806 / MP Rotator Nozzle	+ 23.83	580'
V5	RAIN BIRD 1806 / MP Rotator Nozzle	+ 24.20	1100'
V6	IN LINE DRIP / MICRO SPRAY	+ 15	680'
	MAINLINE 1.5" SCH 200 PVC		60'

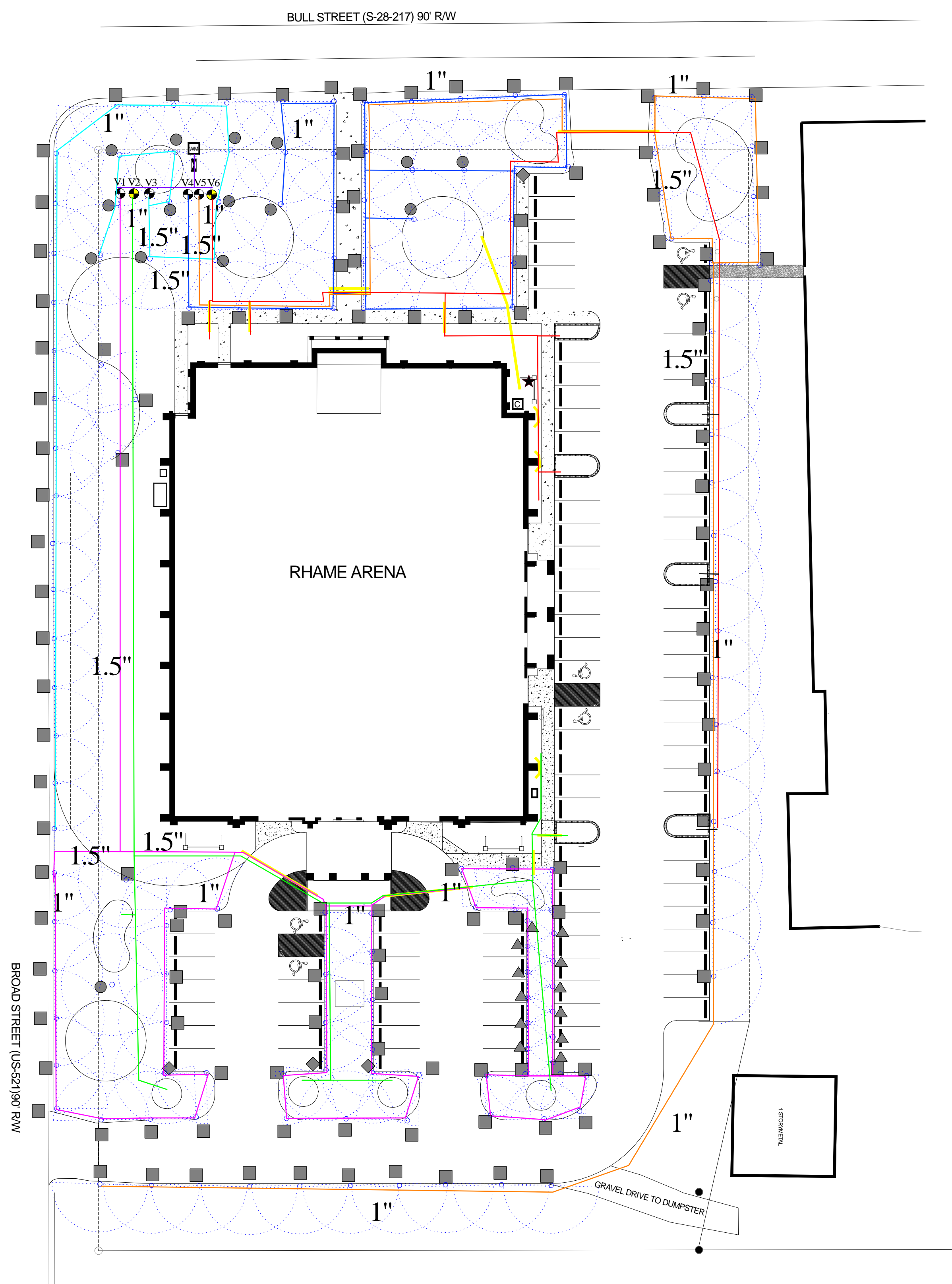

Notes

- 1) Contractor is responsible to have all utilities located.
- 2) No trenches or pits may be left unattended or open overnight.
- 3) All trenches must be compacted to avoid settling. Contractor will be responsible to correct any settling issues.
- 4) All valve box pit must be installed on a bed of drainage stone.
- 5) A flow test must be performed to insure at least 40 gallons per minute is provided by the water meter.
- 6) Main irrigation line is 1 1/2" schedule 200 PVC pipe and all lateral lines are 1 1/2" schedule 200 PVC pipe and 1" sch 200 PVC for MP Rotator zones. The lateral lines for the drip zones are 1" sch 200 PVC.